



Multi-Diag Specialist



Ausland Technology Co., Limited

info@cnausland.com

Tel: +86 755 83465332

www.cnausland.com

MDS-9099 User Manual





MDS-9099 DESCRIPTION-----P2

FN KEY DESCRIPTION-----P4

MAIN MENU OVERVIEW-----P5

CABLE CONNECTION-----P6

TECHNICAL SPECIFICATION-----P7

STANDARD PACKAGE-----P7

OPERATION PROCEDURES-----P8

Provides affordable prices with more than 44 car makes for workshops base on different software configurations

MDS-9099 DESCRIPTION

15 - Airbags	
[1]	64-Basic setting
[2]	10-Adaptation

- Retrieve ABS/SRS ECU information Steering angle sensor calibration
- Clear adaptation
- Record, store & replay live data

Customize	
[176]	Fr & Rr Buzzer Frequency
[177]	Keep Sense Buzzer
[178]	Rr Sensor Onset Range
[179]	Fr Sensor Onset Range
[180]	Fr Side Sens Actuation Setting
[181]	Front Side Dist Sensor

- O2 sensor test -- allowing retrieval and viewing of O2 sensor test results for most recently performed tests from the vehicle's on-board computer

Customize	
[81]	Wireless Lock Function with Doors
[82]	Panic Function
[83]	Unlock Z Operation
[84]	Truck Lid Operation
[85]	Wireless Glass Hatch Open
[86]	Wireless Buzzer Vol

- Full ECUs diagnosis with OBDII-16 for engine (gasoline & 12V diesel), auto transmission, abs, air bag, air conditioning, instrument cluster, Immobilize system, EPB and more

Enter With Input VIN										
Y9YF8447D299999										
0	1	2	3	4	5	6	7	8	9	-
Q	W	E	R	T	Y	U	I	O	P	-
A	S	D	F	G	H	J	K	L	M	-
Z	X	C	V	B	N	M	J	I	-	-
abc	SPACE	BackSpace								

- Vehicle information - displaying the vehicle identification number (VIN), the calibration verification number (CVN), and other information of the test vehicle

American Ford	
[1]	Year (2016)
[2]	Year (2017)
[3]	Year (2016)
[4]	Year (2015)
[5]	Year (2014)
[6]	Year (2013)

- Support models 1996 to latest model Test modes mainly include: CANBUS, ISO9141, KWP2000, J1850etc

 English	 Polski	 日本語
 Magyar	 русский	 Português

- Multi-Language: English, German, Dutch, Spanish, French, Portuguese, Russian etc



- MDS multi-diag specialist designed for DIY and professional technicians
- Enlarged 3.5" TFT LCD
- Upgrade online via USB 2.0

Special Function	
[1]	AIT Code Registration
[2]	AIT Code Reset
[3]	All Readiness
[4]	Check Mode
[5]	CVT Oil Pressure Calibration
[6]	Engine Oil Jet Control Check

- I/M readiness - indicating whether or not the various emissions-related systems on the vehicle are operating properly and are ready for inspection and maintenance testing

Special Function	
[1]	Service Light Reset

- Oil light/service reset - supporting service lamp reset, brake pad reset service mileage, check engine light, and service intervals

- Read & clear trouble code (generic & manufacturer specific DTC's) on all the systems such as engine, transmission, abs and airbag
- On-board readiness monitoring - to read the results of on-board diagnostic monitoring tests for specific components/systems
- Freeze frame - providing freeze frame data as snapshot of the operating conditions at the time of an emission-related fault
- EVAP test - initiating a leak test for the vehicle's EVAP system with necessary procedures available
- Fuel injection (all gasoline & 12V diesel)
- Turn off the ECU warning light, diagnoses EPB/SBC functionality
- View & graph live data for real time graphing /live data reading
- Component for bi-directional tests such as cycling abs solenoids
- Re-calibration of brake control module after changing the brake pads replacement

FN KEY DESCRIPTIONS

5-FUNCTION SUPPORTED

F1
Enter With Input VIN
To input message

F2
Diagnosis Request
To select live data

F3
To set favorite car

F4
Special Function
Special functions

F5
Used as Tab Key

MAIN MENU OVERVIEW

Diagnose
To test the car

Favorite
Set favorite cars

OBD-II
OBDII test

Setting
Main unit setting

About
Main unit information

American
Test American cars

Asian
Test Asian cars

European
Test European cars

Language
19 Languages

Unit
Unit setting

Sound
Sound setting

Data Record
Saved to TF card

Button Test
Keys Testing

LCD
LCD Testing

CABLE CONNECTION

- Locate vehicle's DLC socket; it provides standard 16 pins and is generally located on the driver's side, about 12 inch away from the center of dashboard.
- If DLC is not equipped under dashboard, an label indicating its position will be given.
- In case no DLC is found, please refer to Automobile Repair Manual.
- Note: Remember to remove the diagnostic connector from the DLC if it keeps unattended.
- Plug one end of the diagnostic cable into the DB connector and the other end into the vehicle's DLC. For vehicles with non-16PIN DLC, please choose the desired connector

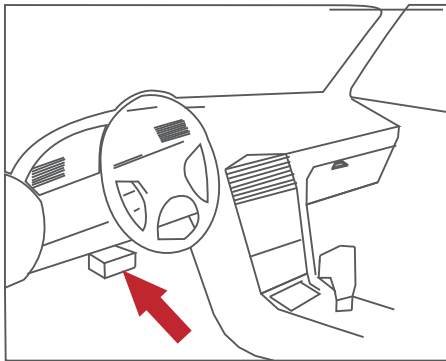

TECHNICAL SPECIFICATION

- Display: 3.5" TFT LCD
- Operation Temperature: 0°C - 50°C
- Storage Temperature: -20°C - 70°C
- Operating current: 150mA 12V(Typical)
- Power consumption:1.8W(Typical)
- Dimension:175.75 x102.03 x 33.2mm (LxWxH)
- Weight:270g

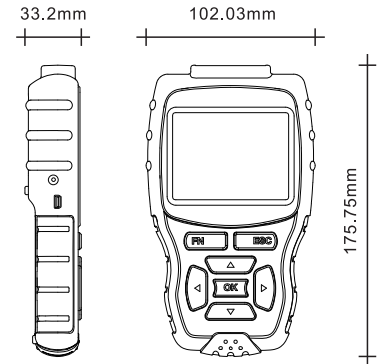

STANDARD PACKAGE



- MDS Main Unit
- Main cable
- OBD-II connector(OBD-I Option)
- USB cable
- TF card
- User Manual

OPERATION PROCEDURES

To start a new test

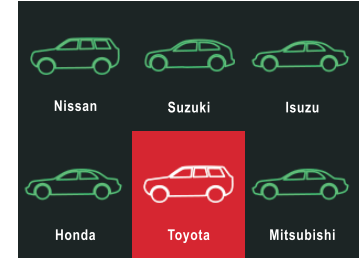
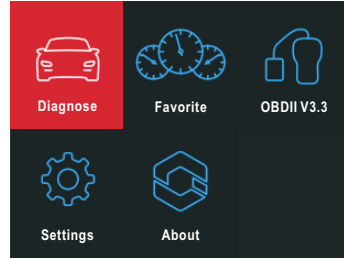

To select the vehicle base on makes, models and years

TOYOTA	
[1]	Auto Scan
[2]	System Selected
[3]	History Record

Please Select	
[1]	TACOMA
[2]	YARIS
[3]	YARIS R
[4]	CAMRY
[5]	CROWN
[6]	HIGHLANDER

Please Select	
[1]	Others
[2]	Radar Cruise

Please Select	
[1]	System Select
[2]	Health Check
[3]	Service View
[4]	Customize Setting

To select the system for diagnostic function

Please Select	
[1]	Powertrain
[2]	Chassis
[3]	Body

Please Select	
[1]	Engine
[2]	Transmission
[3]	Stop and Start
[4]	Cruise Control

Diag Function Select	
[1]	Read Trouble Code
[2]	Clear Trouble Code
[3]	Read Data Stream
[4]	Active Test
[5]	Special Function

OPERATION PROCEDURES

To read trouble code

Diag Function Select	
[1]	Read Trouble Code
[2]	Clear Trouble Code
[3]	Read Data Stream
[4]	Active Test
[5]	Special Function

Read Trouble Code	
P0003	Fuel Volume Regulator Control Circuit Low [Test Failed Trouble Code Pending Trouble Code Current Trouble Code]
P0780	Shift Error
C0000	Vehicle Speed Information circuit malfunction
U2000	No response from the audio remote chassis unit (RCU)

To clear trouble code

Diag Function Select	
[1]	Read Trouble Code
[2]	Clear Trouble Code
[3]	Read Data Stream
[4]	Active Test
[5]	Special Function

Information

Do you want to erase all the fault code(s)?

Information

Clear trouble codes successfully!

Press "OK" to continue

To read data stream

Diag Function Select	
[1]	Read Trouble Code
[2]	Clear Trouble Code
[3]	Read Data Stream
[4]	Active Test
[5]	Special Function

Data Stream Group Selected	
[1]	All Data
[2]	Primary
[3]	Engine Control
[4]	Gas General / Ptrl General
[5]	Gas AF Control / Ptrl AF General
[6]	Gas AF Control (D4) / Ptrl AF Control (D4)

Data Stream		
[1]	Vehicle Speed	158(mph)
[2]	Engine Speed	16383(rpm)
[3]	Calculate Load	100.0(%)
[4]	Vehicle Load	25700.0(%)
[5]	Mass Air Flow Sensor	655.35(gm/sec)
[6]	Atmospheric Pressure	3(Bar)

Information

Please select one or two items that you want to show graph.

Press "OK" to continue

OPERATION PROCEDURES

To start active test or special function

Diag Function Select	
[1]	Read Trouble Code
[2]	Clear Trouble Code
[3]	Read Data Stream
[4]	Active Test
[5]	Special Function

Active Test	
[1]	001 Control the Injection Volume
[2]	002 Control the Injection Volume for A/F Sensor
[3]	003 Activate the VSV for Intake Control
[4]	004 Control the ACIS VSV Motor Duty Ratio
[5]	005 Activate the EVAP Purge VSV
[6]	006 Activate the Air Bypass Valve

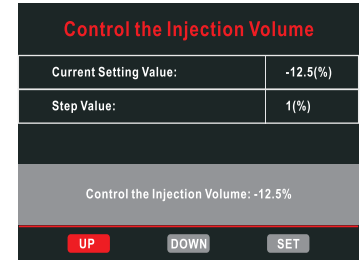
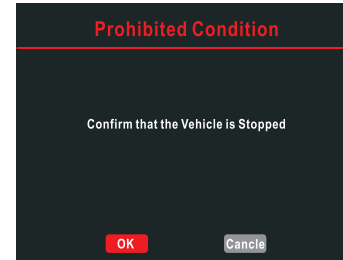

To shift function area with the Function Key FN

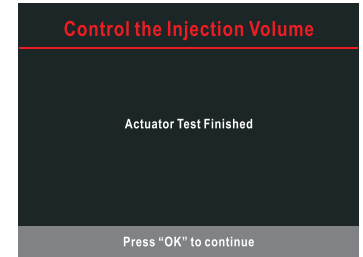
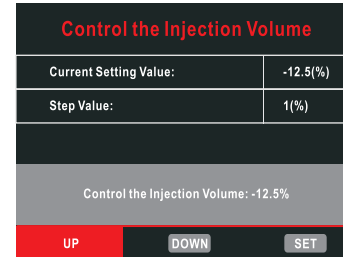
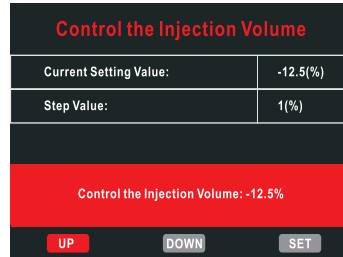
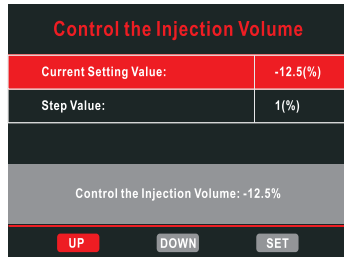

To set values and input numbers required (the FN key is used to load the software keyboard)

